

Section 2

Fuseal® Corrosive Waste  
Piping System



# Table of Contents

## **Fuseal Corrosive Waste Piping System**

---

Pipe 2.4

---

Fusion Fittings - PP Flame Retardant 2.6

---

Cleanouts and Floor Drains - PP Flame Retardant 2.16

---

Traps - PP Flame Retardant 2.18

---

Large Diameter Fusion Fittings - PP Flame Retardant 2.22

---

Large Diameter Fusion Fittings - PP Non-Flame Retardant 2.26

---

Fusion Accessories 2.31

---

Mechanical Joint Fittings - PP Flame Retardant 2.31

---

Neutralization Tanks and Accessories 2.32

---

Tank Order Sheet 2.37

---

Submittals 2.38

## Glossary

S	= Fuseal Electrofusion Socket
SPG	= Spigot End (same dimension as pipe outside diameter)
FT	= Female Thread (Straight)
MT	= Male Thread (Straight)
MPT	= Male Pipe Thread
FPT	= Female Pipe Thread
MJ	= Mechanical Joint Socket
PPFR	= Polypropylene Flame Retardant
PPNFR	= Polypropylene Non-Flame Retardant

## Product Line      Description

07	Fusion Accessories
22	PPNFR Sch. 40 pipe
23	PPFR Sch. 40 pipe
26	PPFR Sch. 80 pipe
28	PPNFR Sch. 80 pipe
30	Neutralization Tanks and Accessories
21	PPNFR Fusion Fittings-Fab
51	PPFR Fusion Fittings-Fab
52	PPFR Fusion Fittings-Molded
53	PPFR MJ Fittings

The technical information given in this publication implies no warranty of any kind and is subject to change without notice. Please consult our Terms and Conditions of Sale.

## Not for Use with Compressed Air or Gases

### DO NOT TEST with Air or Air over Water

GF Piping DOES NOT RECOMMEND the use of thermoplastic piping products for systems to transport or store compressed air or gases, or the testing of thermoplastic piping systems with compressed air or gases in above or below ground locations. The use of GF Piping products in compressed air or gas systems automatically voids the warranty for such products, and their use against our recommendation is entirely the responsibility and liability of the installer. GF Piping will not accept responsibility for damage or impairment from its products, or other consequential or incidental damages caused by misapplication, incorrect assembly, and/or exposure to harmful substances or conditions.

**For more information about any of our product lines, please call (800) 423-2686.**

# Fuseal®

## Corrosive Waste Pipe – Schedule 40 and 80

Material: Flame Retardant and Non-Flame Retardant Polypropylene

### PPFR Schedule 40 Group I

1½" - 6" are 10 ft. lengths

8", 10" and 12" are 20 ft. lengths

P/L 23

Inch Size	Part Number	Lift Qty (ft.)	avg. od	min. wall
1½	*F8004-015AA	1800	1.900	0.145
2	*F8004-020AA	1050	2.375	0.154
3	*F8004-030AA	580	3.500	0.216
4	*F8004-040AA	510	4.500	0.237
6	*F8004-060AA	220	6.625	0.280
8	*F8004-080AB	280	8.625	0.322
10	*F8004-100AB	220	10.750	0.365
12	*F8004-120AB	100	12.750	0.406

Note: 20' lengths available upon request

### PPFR Schedule 80 Group I Pipe – 10 ft. lengths

P/L 26

Inch Size	Part Number	Lift Qty (ft.)	avg. od	min. wall
1½	*F8008-015AA	1800	1.900	0.200
2	*F8008-020AA	1050	2.375	0.281
3	*F8008-030AA	580	3.500	0.300
4	*F8008-040AA	510	4.500	0.337
6	*F8008-060AA	220	6.625	0.432

Note: 20' lengths available upon request

^ = 40% Restock Charge

\* = Non-Cancelable / Non-Returnable

Dimensions are subject to change. Please see online "Price Lists" at <http://www.gfpiping.com> for up-to-date information.

## PPNFR Schedule 40 Group I Pipe – 20 ft. lengths

P/L 22

Inch Size	Part Number	Lift Qty (ft.)	avg. od	min. wall
1½	*P8004-015AB	3600	1.900	0.145
2	*P8004-020AB	2100	2.375	0.154
3	*P8004-030AB	1160	3.500	0.216
4	*P8004-040AB	1020	4.500	0.237
6	*P8004-060AB	440	6.625	0.280
8	*P8004-080AB	280	8.625	0.322
10	*P8004-100AB	220	10.750	0.365
12	*P8004-120AB	100	12.750	0.406
14	*P8004-140AB	100	14.000	0.437
16	*P8004-160AB	100	16.000	0.500

## PPNFR Schedule 80 Group II Pipe – 20 ft. lengths

P/L 28

Inch Size	Part Number	Lift Qty (ft.)	avg. od	min. wall
1½	*R8008-015AB	3600	1.900	0.200
2	*R8008-020AB	2100	2.375	0.281
3	*R8008-030AB	1160	3.500	0.300
4	*R8008-040AB	1020	4.500	0.337
6	*R8008-060AB	440	6.625	0.432
8	*R8008-080AB	280	8.625	0.500
10	*R8008-100AB	220	10.750	0.593
12	*R8008-120AB	100	12.750	0.687

Fuseal PP

^ = 40% Restock Charge

\* = Non-Cancelable / Non-Returnable

Dimensions are subject to change. Please see online "Price Lists" at <http://www.gfpiping.com> for up-to-date information.

## PPFR Fusion Fittings – Schedule 40

P/L 51 Fabricated (part number ends with "F")

P/L 52 Molded

Material: Flame Retardant Polypropylene

6" fittings require the use of a metal band clamp; metal band clamps must be ordered separately.

**Note:** Custom fittings available on request.

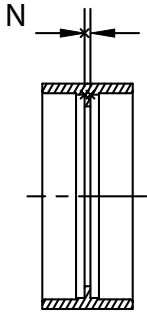

### Coupling (S x S)

Inch Size	Part Number	Std. Pack	N
1½	527001	50	0.06
2	527002	45	0.06
3	527003	60	0.13
4	527004	20	0.13
6	527006	10	0.19

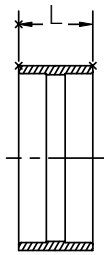

### Sleeve Coupling (S x S)

Inch Size	Part Number	Std. Pack	L
1½	527041	2	1.56
2	527042	2	1.81
3	527043	2	2.00
4	527044	2	2.00
6	527046	2	2.69

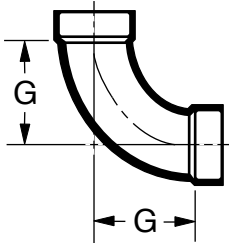

### 1/4 Bend – Long Sweep (S x S)

Inch Size	Part Number	Std. Pack	G
1½	526276	30	2.75
2	526277	30	3.25
3	526278	15	4.06
4	526279	4	4.94
6	*526280F	2	11.00

^ = 40% Restock Charge

\* = Non-Cancelable / Non-Returnable

Dimensions are subject to change. Please see online "Price Lists" at <http://www.gfpiping.com> for up-to-date information.

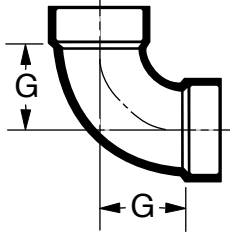

### 1/4 Bend – Short Sweep (S x S)

Inch Size	Part Number	Std. Pack	G
1½	526251	45	1.75
2	526252	25	2.31
3	526253	30	3.06
4	526254	10	3.88
6	526256	5	5.63

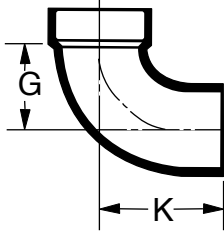

### 1/4 Bend – Street (Spg x S)

Inch Size	Part Number	Std. Pack	G	K
1½	526451	35	1.75	3.11
2	526452	30	2.31	3.80
3	526453	5	3.06	4.75
4	526454	5	3.88	5.38
6	*526456F	2	11.00	10.81

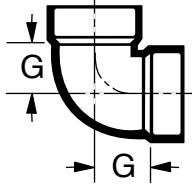

### 1/4 Bend – Vent (S x S)

Inch Size	Part Number	Std. Pack	G
1½	526201	40	1.19
2	526202	30	1.50
3	526203	5	1.88

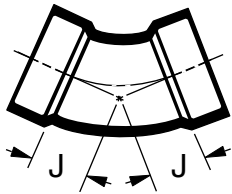

### 1/6 Bend (S x S)

Inch Size	Part Number	Std. Pack	J
1½	526601	10	1.00
2	526602	10	1.31
3	526603	5	1.69
4	526604	2	2.06

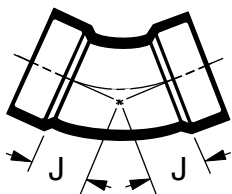

### 1/8 Bend (S x S)

Inch Size	Part Number	Std. Pack	K
1½	526501	40	1.13
2	526502	25	1.50
3	526503	20	1.75
4	526504	10	2.19
6	526506	5	3.37

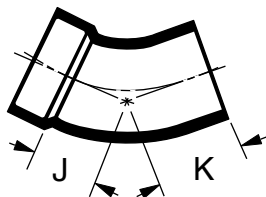

### 1/8 Bend – Street (Spg x S)

Inch Size	Part Number	Std. Pack	J	K
1½	526401	45	1.13	2.44
2	526402	30	1.50	2.50
3	526403	15	1.75	3.25
4	526404	10	2.19	3.25
6	526406	5	3.38	4.75

^ = 40% Restock Charge

\* = Non-Cancelable / Non-Returnable

Dimensions are subject to change. Please see online "Price Lists" at <http://www.gfpiping.com> for up-to-date information.

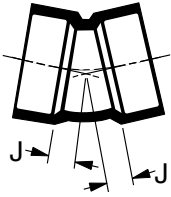

### 1/16 Bend (S x S)

Inch Size	Part Number	Std. Pack	J
1½	526551	15	0.50
2	526552	15	0.69
3	526553	2	0.81
4	526554	5	1.00

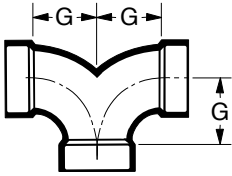

### 3-Way Ell (S x S x S)

Inch Size	Part Number	Std. Pack	G
1½	526261	5	1.75
2	526262	10	2.31

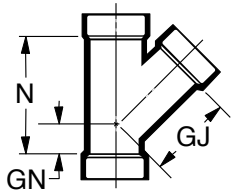

### 45° Wye (S x S x S)

Inch Size	Part Number	Std. Pack	GJ	GN	N
1½	526301	20	2.88	1.13	4.00
2	526302	10	3.63	1.38	5.00
3	526303	10	5.00	1.63	6.63
4	526304	5	6.38	1.88	8.25
6	526306	2	9.13	1.63	10.75

### 45° Wye – Reducing (S x S x S)

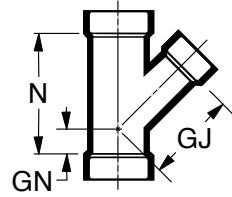

Inch Size	Part Number	Std. Pack	GJ	GN	N
2x2x1½	526325	20	3.44	1.06	4.38
3x3x1½	526324	15	4.63	0.88	5.00
3x3x2	526326	15	4.63	0.88	5.00
4x4x2	526328	10	5.56	0.38	5.06
4x4x3	526327	10	6.00	1.06	6.63
6x6x2	526342	2	6.75	-1.13	4.73
6x6x3	526343	3	7.43	0.19	6.38
6x6x4	526344	4	7.75	0.68	7.73

### 45° Wye – Double (S x S x S x S)

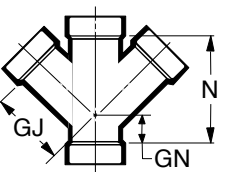

Inch Size	Part Number	Std. Pack	GJ	GN	N
1½	526380	4	3.50	1.13	4.63
2	526381	4	4.00	1.38	5.38
3	526382	1	5.00	1.63	7.63
4	526383	1	6.38	1.88	9.25
6	*526351F	1	12.25	6.18	18.38

^ = 40% Restock Charge

\* = Non-Cancelable / Non-Returnable

Dimensions are subject to change. Please see online "Price Lists" at <http://www.gfpiping.com> for up-to-date information.



### 45° Wye – Double Reducing (S x S x S x S)

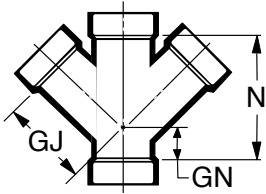

Inch Size	Part Number	Std. Pack	GJ	GN	N
2x2x1½x1½	526384	2	3.44	1.06	5.38
3x3x1½x1½	526389	1	4.31	.50	5.25
3x3x2x2	526385	1	4.63	.88	6.00
4x4x2x2	526386	1	5.56	.38	6.06
4x4x3x3	526387	1	6.00	1.06	7.63
6x6x3x3	*526390F	1	9.25	0.68	7.73
6x6x4x4	526388	1	7.75	0.69	7.73

### Long Turn Tee Wye (S x S x S)

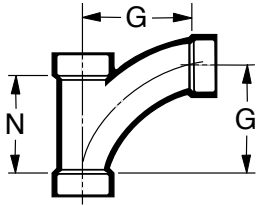

Inch Size	Part Number	Std. Pack	G	N
1½	527301	20	3.94	3.63
2	527302	25	5.13	4.44
3	527303	10	7.56	6.50
4	527304	5	9.82	8.75

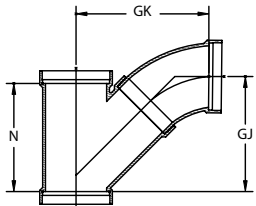

### Wye and 1/8 Combo Bend (S x S x S)

Inch Size	Part Number	Std. Pack	GJ	GK	N
6	*527306F	1	11.41	13.18	10.75

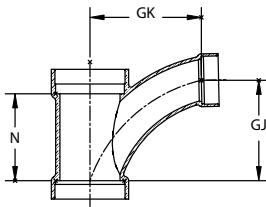

### Long Turn Tee Wye – Reducing (S x S x S)

Inch Size	Part Number	Std. Pack	GJ	GK	N
2x2x1½	527320	20	3.94	4.19	3.63
3x3x1½	527326	15	3.94	4.75	3.81
3x3x2	527327	12	5.13	5.69	4.75
4x4x2	527337	5	5.13	6.13	4.50
4x4x3	527338	8	7.56	8.06	6.50

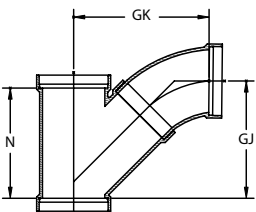

### Combo Wye and 1/8 Bend – Reducing (S x S x S)

Inch Size	Part Number	Std. Pack	GJ	GK	N
6x6x2	*527344F	1	8.06	5.44	4.75
6x6x3	*527339F	1	5.44	9.19	4.73
6x6x4	*527340F	1	4.73	9.94	7.73

^ = 40% Restock Charge

\* = Non-Cancelable / Non-Returnable

Dimensions are subject to change. Please see online "Price Lists" at <http://www.gfpiping.com> for up-to-date information.

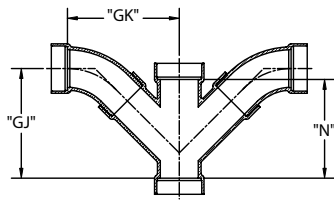

### Combo Wye and 1/8 Bend – Double (S x S x S x S)

Inch Size	Part Number	Std. Pack	GJ	GK	N
1½	526801	1	5.31	5.31	4.63
2	526802	1	5.98	6.10	5.38
3	526803	1	7.47	7.59	7.63
4	526804	1	8.69	9.00	9.25
6	*526806F	1	18.18	15.38	18.38

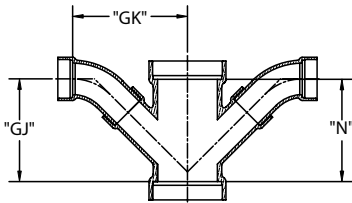

### Combo Wye and 1/8 Bend – Double Reducing (S x S x S x S)

Inch Size	Part Number	Std. Pack	GJ	GK	N
2x2x1½x1½	526825	1	5.22	5.27	5.38
3x3x1½x1½	526824	1	5.27	5.89	5.25
3x3x2x2	526826	1	5.91	6.54	6.00
4x4x2x2	526828	1	6.08	7.20	6.06
4x4x3x3	526827	1	7.61	8.29	7.63
6x6x3x3	*526843F	1	9.52	10.59	7.73
6x6x4x4	*526844F	1	8.46	9.97	7.73

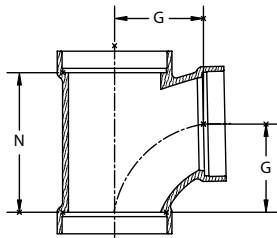

### Sanitary Tee (S x S x S)

Inch Size	Part Number	Std. Pack	G	N
1½	526151	50	1.75	2.75
2	526152	10	2.31	3.69
3	526153	15	3.06	4.88
4	526154	12	3.88	6.13
6	*526156F	1	14.25	20.38

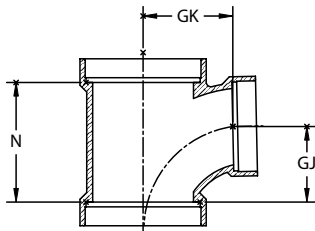

### Sanitary Tee – Reducing (S x S x S)

Inch Size	Part Number	Std. Pack	GJ	GK	N
2x2x1½	526126	30	1.96	2.21	3.17
3x3x1½	526131	15	1.75	2.56	2.68
3x3x2	526130	20	2.13	2.88	3.31
4x4x2	526134	10	2.06	3.31	3.19
4x4x3	526136	5	3.00	3.56	4.75
6x6x2	*526137F	2	3.93	6.00	6.13
6x6x3	*526138F	2	3.93	6.40	6.13
6x6x4	526139	2	3.93	4.90	6.13

^ = 40% Restock Charge

\* = Non-Cancelable / Non-Returnable

Dimensions are subject to change. Please see online "Price Lists" at <http://www.gfpiping.com> for up-to-date information.

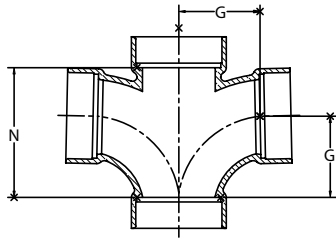

### Sanitary Tee – Double (S x S x S x S)

Inch Size	Part Number	Std. Pack	G	N
1½	526187	5	1.75	2.75
2	526186	5	2.31	3.69
4	526185	4	4.50	6.13

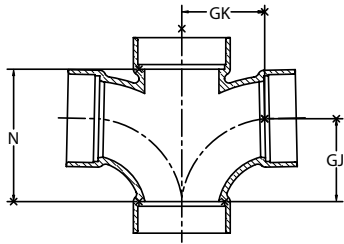

### Sanitary Tee – Double Reducing (S x S x S x S)

Inch Size	Part Number	Std. Pack	GJ	GK	N
2x2x1½x1½	526188	2	1.94	2.19	3.13
3x3x1½x1½	*526184F	2	2.13	4.38	2.13
3x3x2x2	526181	2	2.13	2.88	3.13

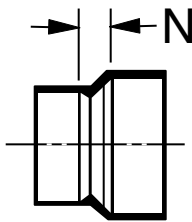

### Pipe Increaser (S x S)

Inch Size	Part Number	Std. Pack	N
1½x2	527022	40	0.53
1½x3	*527023F	15	2.63
2x3	527024	15	0.88
2x4	527025	5	1.38
3x4	527026	5	0.94
3x6	*527027F	1	1.81
4x6	*527028F	1	1.63

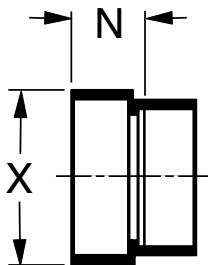

### Reducer Bushing (Spg x S)

Inch Size	Part Number	Std. Pack	N	X
2x1½	526752	30	1.61	2.38
3x1½	526762	15	1.50	3.50
3x2	526754	40	1.50	3.50
4x2	526758	15	1.13	4.50
4x3	526756	20	1.50	4.50
6x4	526767	10	1.28	6.63

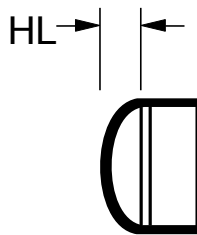

### Cap (S)

Inch Size	Part Number	Std. Pack	HL
1½	527081	35	0.53
2	527082	50	0.32
3	527083	20	0.91
4	527084	5	1.09
6	527087	2	1.56

^ = 40% Restock Charge

\* = Non-Cancelable / Non-Returnable

Dimensions are subject to change. Please see online "Price Lists" at <http://www.gfpiping.com> for up-to-date information.

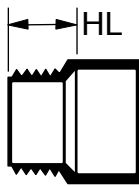

### Male Adapter (S x MPT)

Inch Size	Part Number	Std. Pack	HL
1½	526871	50	1.18
2	526872	40	1.25
3	526873	15	1.84
4	526874	10	2.00
6	*526876F	1	3.50

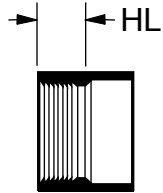

### Female Adapter (S x FPT)

Inch Size	Part Number	Std. Pack	HL
1½	526891	50	1.12
2	526892	50	1.15
3	526893	18	1.72
4	526894	10	1.81
6	526896	2	2.82

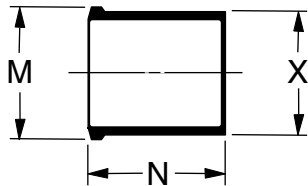

### Glass Adapter – (Spg x Glass Pipe Bead)

(used with Beaded Glass Coupling)

Inch Size	Part Number	Std. Pack	M	N	X
1½	*7411	5	2.06	2.00	1.90
2	*7412	5	2.58	2.00	2.38
3	*7413	5	3.69	2.50	3.50
4	*7414	5	4.84	2.50	4.50
6	*7416	1	7.12	3.00	6.63

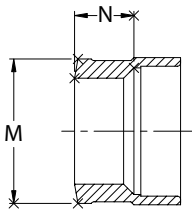

### Iron Pipe Adapter (S x Iron Pipe Bead)

(used with High Silicon Iron Pipe Coupling)

Inch Size	Part Number	Std. Pack	M	N
1½	*527431	5	2.25	1.88
2	*527432	5	2.72	2.00
3	*527433	5	3.81	2.63
4	*527434	2	4.81	2.63

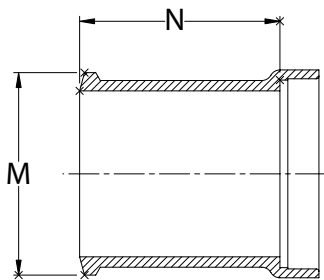

### Caulked Joint Adapter – (S x Caulked Joint Bead)

(used with Caulked Joint Coupling)

Inch Size	Part Number	Std. Pack	N	M
1½	*527441	5	4.50	2.38
2	*527442	5	4.25	2.88
3	*527443	5	4.65	3.88
4	*527444	2	4.83	4.88

^ = 40% Restock Charge

\* = Non-Cancelable / Non-Returnable

Dimensions are subject to change. Please see online "Price Lists" at <http://www.gfpiping.com> for up-to-date information.

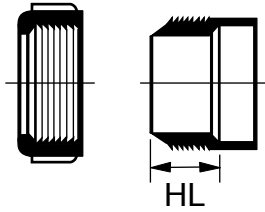

### Lead Pipe Adapter – (S x Flare)

Inch Size	Part Number	Std. Pack	HL
1½	*527401	5	1.12

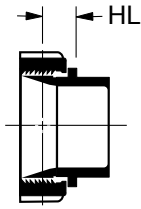

### Polyethylene Adapter – (HDPE Socket x Female Union Nut)

Inch Size	Part Number	Std. Pack	HL
1½	*7268A	5	0.63
2	*7278A	5	0.75

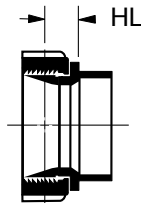

### Female Union Nut Adapter – (S x Female Union Nut)

Inch Size	Part Number	Std. Pack	HL
1½	*527260A	10	0.63
2	*527270A	10	0.75

### Female Union Nut Adapter – (Spg x Female Union Nut)

Inch Size	Part Number	Std. Pack	HL
1½	*7262A	10	0.63

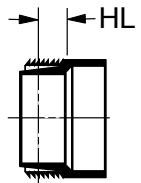

### Male Union Adapter – (S x Male Union)

Inch Size	Part Number	Std. Pack	HL
1½	*527264	5	0.44

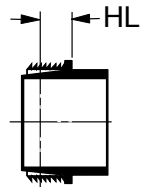

### Male Union Adapter – (Spg x Male Union)

Inch Size	Part Number	Std. Pack	HL
2	*7276	5	0.56

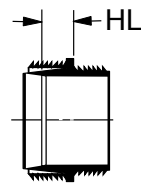

### Male Union Adapter – (MPT x Male Union)

Inch Size	Part Number	Std. Pack	HL
2	*7277	5	0.56

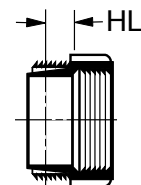

### Male Union Adapter – (FPT x Male Union)

Inch Size	Part Number	Std. Pack	HL
2	*7275	5	0.50

^ = 40% Restock Charge

\* = Non-Cancelable / Non-Returnable

Dimensions are subject to change. Please see online "Price Lists" at <http://www.gfpiping.com> for up-to-date information.

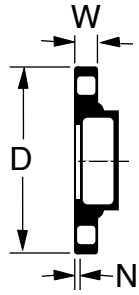

### Van Stone Flange – ANSI 150lb. Pattern (S)

Inch Size	Part Number	Std. Pack	# holes	bolt hole dia.	bolt cir. dia.	D	N	R
1½	526931	10	4	0.56	3.88	5.00	0.31	0.75
2	526932	10	4	0.68	4.75	6.00	0.34	0.81
3	526933	8	4	0.75	6.00	7.50	0.44	1.00
4	526934	10	8	0.75	7.50	9.00	0.42	1.10
6	526936	3	8	0.88	9.50	10.94	0.45	1.26

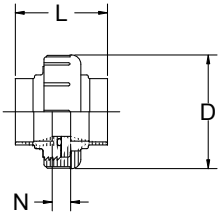

### Union (PPFR x PPFR)/PPFR Nut (S x S)

Inch Size	Part Number	Std. Pack	D	L	N
1½	528291	2	3.75	3.38	0.37
2	528292	2	4.63	3.68	0.68
3	528293	2	6.74	4.68	0.90
4	528294	2	8.38	5.54	1.00

O-Ring material: FPM

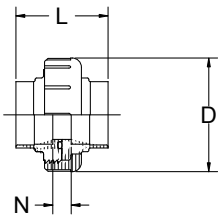

### Union (PPFR x PPFR)/PPFR Nut (S x S)

Inch Size	Part Number	Std. Pack	D	L	N
1½	527271	2	3.75	3.38	0.37
2	527272	2	4.63	3.68	0.68
3	527273	2	6.74	4.68	0.90
4	527274	2	8.38	5.54	1.00

O-Ring material: EPDM

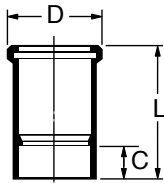

### Vertical/Horizontal Expansion Joint (Spg x S)

Inch Size	Part Number	Std. Pack	A	B	C	D	L
1½	*527811A	1	0.97	4.09	0.75	2.65	4.10
2	*527812A	1	1.19	4.53	0.88	3.15	4.50
3	*527813A	1	1.59	5.31	0.94	4.64	5.25
4	*527814A	1	2.09	6.34	0.94	5.78	5.69

O-Ring material: EPDM

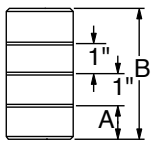

^ = 40% Restock Charge

\* = Non-Cancelable / Non-Returnable

Dimensions are subject to change. Please see online "Price Lists" at <http://www.gfpiping.com> for up-to-date information.

# Fuseal Cleanouts and Floor Drains

P/L 51 Fabricated (part number ends with "F")

P/L 52 Molded

Material: Flame Retardant Polypropylene

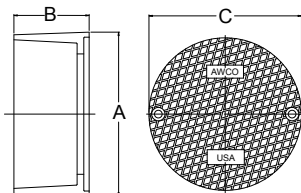

## Nickel Bronze Floor Clean-out Housing

Inch Size	Part Number	Std. Pack	A	B	C
All	*527715A	1	6.13	2.81	5.70

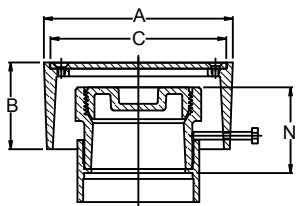

## Nickel Bronze Floor Clean-out Assembly (S)

Inch Size	Part Number	Std. Pack	A	B	C	N
3	*527713A	1	6.13	2.81	5.70	2.78
4	*527714A	1	6.13	2.81	5.70	3.06

Note: 2" adjustment

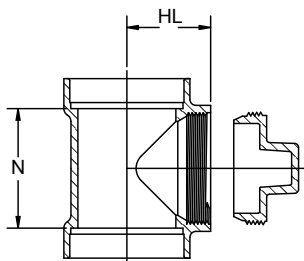

## Cleanout Tee with Plug (S x S x FT)

Inch Size	Part Number	Std. Pack	HL	N
1½	526114A	5	1.82	2.12
2	526115A	15	2.13	2.74
3	526116A	5	2.63	3.75
4	526117A	10	3.38	5.00
6	*526118AF	1	7.00	18.00

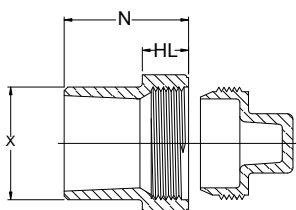

## Cleanout Adapter with Plug (Spg x FT)

Inch Size	Part Number	Std. Pack	HL	N	X
1½	7701A	40	0.78	2.09	1.90
2	7702A	50	0.78	2.22	2.38
3	7703A	18	1.09	2.66	3.50
4	7704A	8	1.13	2.94	4.50
6	7706A	5	1.31	2.63	6.63

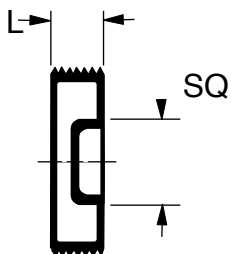

## Countersunk Plug for Cleanout (MT)

Inch Size	Part Number	Std. Pack	L	SQ
3	*7063	10	1.03	1.31
4	*7064	5	1.16	1.63

^ = 40% Restock Charge

\* = Non-Cancelable / Non-Returnable

Dimensions are subject to change. Please see online "Price Lists" at <http://www.gfpiping.com> for up-to-date information.

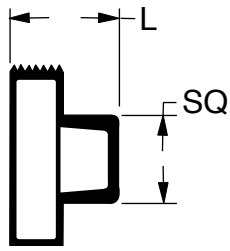

### Plug (MT)

(Used with cleanout tees, cleanout adapters, and cleanout p-traps only)

Inch Size	Part Number	Std. Pack	L	SQ
1	*7049	1	0.99	0.75
Used for 527201A & 527202A only				
1½	*7051	120	1.56	1.00
Also used for 527203A & 527204A				
2	*7052	15	1.54	1.25
3	*7053	5	2.03	1.63
4	*7054	5	2.16	2.00
6	*7057	10	2.38	2.38

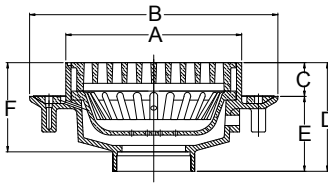

### Floor Drain (S)

Inch Size	Part Number	Std. Pack	A	B	C	D	E	F
2	*527749F	1	8.50	12.00	1.63	6.69	5.06	5.81
3	527750	1	8.50	12.00	1.63	5.25	3.63	4.31
4	527751	1	8.50	12.00	1.63	5.25	3.63	4.31
6	*527752F	1	8.50	12.00	1.63	7.26	5.63	6.00

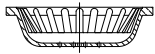

### Replacement Strainer for Floor Drain

Inch Size	Part Number	Std. Pack
All	*7750-2A	5

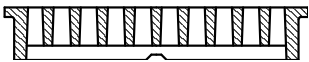

### Replacement Grate for Floor Drain

Inch Size	Part Number	Std. Pack
All	*7750-3A	5

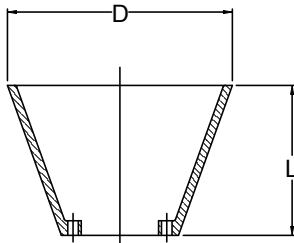

### Anti-Splash Funnel for Floor Drain

Inch Size	Part Number	Std. Pack	D	L
All	*7750-5A	5	6.00	4.00

^ = 40% Restock Charge

\* = Non-Cancelable / Non-Returnable

Dimensions are subject to change. Please see online "Price Lists" at <http://www.gfpiping.com> for up-to-date information.



# Fuseal Traps

P/L 51 Fabricated (part number ends with "F")

P/L 52 Molded

Material: Flame Retardant Polypropylene

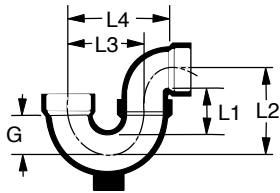

## P Trap with Cleanout (S x S)

Inch Size	Part Number	Std. Pack	G	L1	L2	L3	L4
1½	527201A	35	1.68	2.06	3.64	3.50	4.71
2	527202A	15	2.44	2.71	4.75	5.06	6.94
3	527203A	5	2.79	3.41	6.43	6.75	8.88
4	527204A	5	3.88	3.88	8.06	8.50	10.75

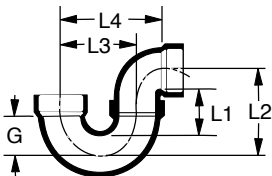

## P Trap (S x S)

Inch Size	Part Number	Std. Pack	G	L1	L2	L3	L4
1½	527201	40	1.68	2.06	3.64	3.50	4.71
2	527202	20	2.44	2.71	4.75	5.06	6.94
3	527203	10	2.79	3.41	6.43	6.75	8.88
4	527204	6	3.88	3.88	8.06	8.50	10.75
6	*527206F	2	5.63	9.19	15.25	15.25	20.88

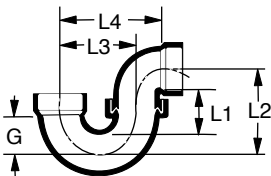

## P Trap - Union Connection (S x S)

Inch Size	Part Number	Std. Pack	G	L1	L2	L3	L4
1½	527211E	30	1.68	2.38	4.00	3.50	4.84
2	527212E	20	2.43	2.84	4.88	5.06	6.50

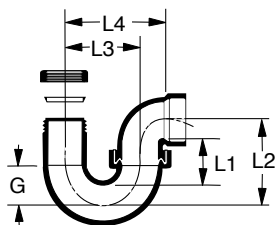

## P Trap - Union Connection (Slip Joint Inlet x S) and (Slip Joint Inlet x FPT)

Inch Size	Part Number	Std. Pack	G	L1	L2	L3	L4
1½	527225	8	1.80	2.08	3.71	3.30	4.51
1½	7225	8	1.80	2.08	3.71	3.30	4.51

^ = 40% Restock Charge

\* = Non-Cancelable / Non-Returnable

Dimensions are subject to change. Please see online "Price Lists" at <http://www.gfpiping.com> for up-to-date information.

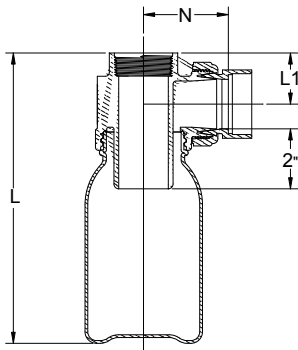

### Jar Trap (FPT Inlet x S Outlet)

Size	Part Number	Std. Pack	N	L	L1
1½	527242C	6	2.75	9.50	1.63

### Polypropylene Jar – Translucent Non-Flame Retardant

Size	Part Number	Std. Pack
1 Quart	*7893	1

### Polypropylene Jar Replacement Gasket

Size	Part Number	Std. Pack
1 Quart	*77241-3	1

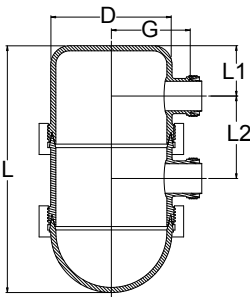

### Drum Trap with Domed Cap (Male Union Thread x Male Union Thread)

Inch Size	Part Number	Std. Pack	D	G	L	L1	L2
1½	7246A	1	6.50	4.31	13.44	2.75	4.50
2	7247A	1	6.50	4.31	13.44	2.75	4.50

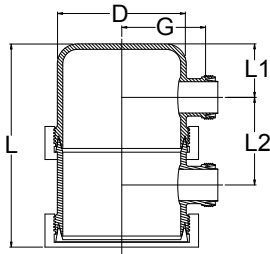

### Drum Trap with Flat Cap (Male Union Thread x Male Union Thread)

Inch Size	Part Number	Std. Pack	D	G	L	L1	L2
1½	7246B	1	6.50	4.31	10.50	2.75	4.50

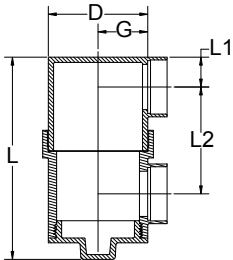

### Drum Trap (S x S)

Must field fuse body

Inch Size	Part Number	Std. Pack	D	G	L	L1	L2
1½	527248	3	4.50	2.25	9.34	1.25	5.13
2	527249	3	4.50	2.38	9.34	1.35	5.13

^ = 40% Restock Charge

\* = Non-Cancelable / Non-Returnable

Dimensions are subject to change. Please see online "Price Lists" at <http://www.gfpiping.com> for up-to-date information.

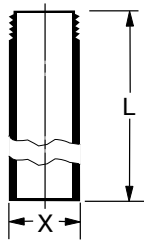

### P Trap Outlet Pipe (Spg x MPT)

Inch Size	Part Number	Std. Pack	L	X
1½	*7538	5	18.00	1.90

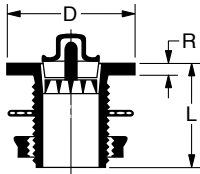

### Sink Strainer Assembly (MT)

Includes sink strainer, gasket, plug and locknut

Inch Size	Part Number	Std. Pack	L	D	R
1½	7841A	20	2.75	3.31	0.25

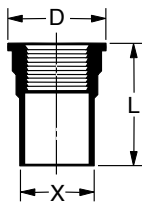

### Sink Strainer Adapter (FT x Spg)

Inch Size	Part Number	Std. Pack	L	D	X
1½	7211-7	5	3.38	2.88	1.90

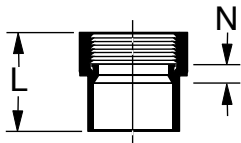

### Swivel Sink Strainer Adapter with Gasket (S x FT)

Inch Size	Part Number	Std. Pack	L	N
1½	527217	5	1.72	0.44

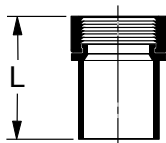

### Swivel Sink Strainer Adapter with Gasket (Spg x FT)

Inch Size	Part Number	Std. Pack	L
1½	7216	5	2.50
1½	7218	10	13.00

### Swivel Sink Strainer Replacement Gasket

Inch Size	Part Number	Std. Pack
1½	*77216-2A	5

^ = 40% Restock Charge

\* = Non-Cancelable / Non-Returnable

Dimensions are subject to change. Please see online "Price Lists" at <http://www.gfpiping.com> for up-to-date information.

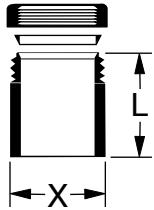

### Tailpiece Adapter – (Spg x Brass Nut)

Inch Size	Part Number	Std. Pack	L	X
1½	*7211X3	25	2.13	1.90

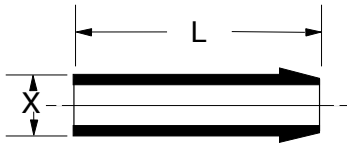

### Overflow Pipe

Inch Size	Part Number	Std. Pack	L	X
1½	*7842	5	7.88	1.90

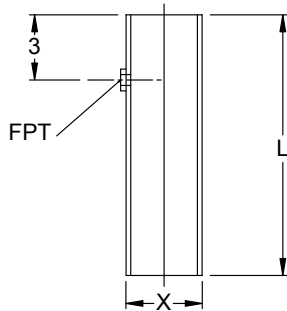

### Trap Primer (Spg x FPT x Spg)

Inch Size	Part Number	Std. Pack	L	X	FPT
1½	*7201	1	12.00	1.90	½
2	*7202	1	12.00	2.38	½
3	*7203	1	12.00	3.50	½
4	*7204	1	12.00	4.50	½
6	*7206	1	12.00	6.63	¾

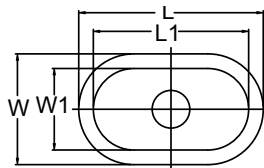

### Cup Sink – 1½” MT Outlet

Includes Sink Strainer, Plug and Retainer Nut

Inch Size	Part Number	Std. Pack	H	H1	L	L1	W	W1
9 x 3 x 4 Deep	7851A	1	7.00	4.00	9.75	8.56	4.50	3.31
6 x 3 x 4 Deep	7852A	1	7.00	4.00	7.50	6.31	4.50	3.31

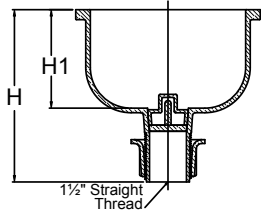

### Replacement Parts for Cup Sink

Description	Part No.	Std. Pack
Strainer	*7850-3A	1
Plug	*7850-4A	1
Gasket	*77216-2A	1

^ = 40% Restock Charge

\* = Non-Cancelable / Non-Returnable

Dimensions are subject to change. Please see online "Price Lists" at <http://www.gfpiping.com> for up-to-date information.

## Large Diameter Fusion Fittings — PPR

P/L 51 Fabricated (Part Number ends with "F")

Material: Flame Retardant Polypropylene;

8" through 12" fittings require the use of a metal band clamp; metal band clamp must be ordered separately

**Note:** Custom fittings available on request

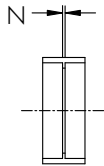

### Coupling (S x S)

Inch Size	Part Number	Std. Pack	N
8	*527008	5	0.25
10	*527100	1	0.25
12	*527120	3	0.25

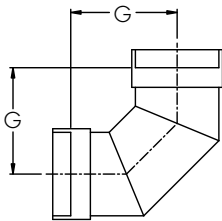

### 1/4 Bend – 3 Segment (S x S)

Inch Size	Part Number	Std. Pack	G
8	*526258F	1	12.25
10	*526255F	1	14.25
12	*526257F	1	16.25

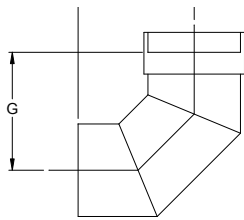

### 1/4 Bend – Street (Spg x S)

Inch Size	Part Number	Std. Pack	G	K
8	*526458F	1	12.25	12.00
10	*526455F	1	14.25	14.00
12	*526457F	1	16.25	16.00

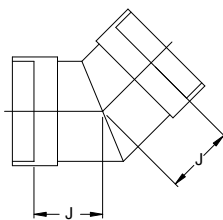

### 1/8 Bend (S x S)

Inch Size	Part Number	Std. Pack	J
8	*526508F	1	6.94
10	*526505F	1	7.75
12	*526507F	1	8.50

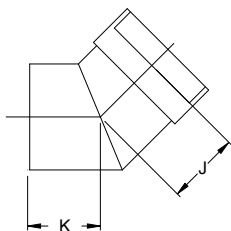

### 1/8 Bend – Street (Spg x S)

Inch Size	Part Number	Std. Pack	J	K
8	*526408F	1	6.94	6.69
10	*526405F	1	7.75	7.25
12	*526407F	1	8.50	8.25

Dimensions are subject to change. Please see online "Price Lists" at <http://www.gfpiping.com> for up-to-date information.

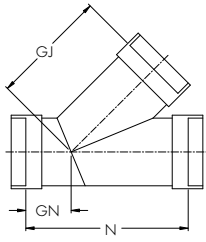

### 45° Wye (S x S x S)

Inch Size	Part Number	Std. Pack	GJ	GN	N
8	*526308F	1	15.50	7.00	22.50
10	*526305F	1	20.75	7.75	28.50
12	*526300F	1	22.00	8.50	30.31

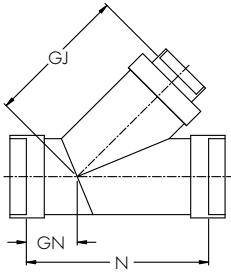

### 45° Wye – Reducing (S x S x S)

Inch Size	Part Number	Std. Pack	GJ	GN	N
8x8x3	*526347F	1	16.82	7.00	22.50
8x8x4	*526346F	1	17.31	7.00	22.50
8x8x6	*526345F	1	17.00	7.00	22.50
10x10x3	*526321F	1	21.69	7.75	28.50
10x10x4	*526322F	1	20.75	7.75	28.50
10x10x6	*526323F	1	22.00	7.75	28.50
10x10x8	*526324F	1	22.63	7.75	28.50
12x12x4	*526332F	1	22.06	8.50	30.31
12x12x6	*526333F	1	23.31	8.50	30.31
12x12x8	*526334F	1	23.75	8.50	30.31
12x12x10	*526335F	1	24.75	8.50	30.31

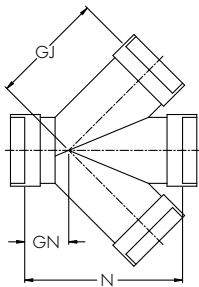

### 45° Wye – Double (S x S x S x S)

Inch Size	Part Number	Std. Pack	GJ	GN	N
8	*526352F	1	15.59	7.00	22.50
10	*526355F	1	20.75	7.75	28.50
12	*526350F	1	22.00	8.50	30.31

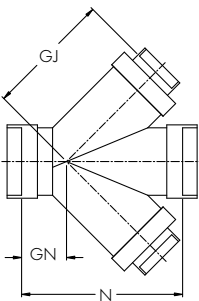

### 45° Wye – Double Reducing (S x S x S x S)

Inch Size	Part Number	Std. Pack	GJ	GN	N
8x8x3x3	*526393F	1	16.82	7.00	22.50
8x8x4x4	*526391F	1	17.31	7.00	22.50
8x8x6x6	*526392F	1	17.00	7.00	22.50
10x10x3x3	*526370F	1	21.75	7.75	28.50
10x10x4x4	*526371F	1	20.75	7.75	28.50
10x10x6x6	*526372F	1	22.25	7.75	28.50
10x10x8x8	*526373F	1	22.75	7.75	28.50
12x12x4x4	*526394F	1	22.06	8.50	30.31
12x12x6x6	*526395F	1	23.50	8.50	30.31
12x12x8x8	*526396F	1	24.00	8.50	30.31
12x12x10x10	*526397F	1	25.00	8.50	30.31

^ = 40% Restock Charge

\* = Non-Cancelable / Non-Returnable

Dimensions are subject to change. Please see online "Price Lists" at <http://www.gfpiping.com> for up-to-date information.

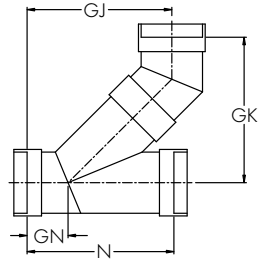

### Combination Wye and 1/8 Bend (S x S x S)

Inch Size	Part Number	Std. Pack	GJ	GK	GN	N
8	*526716F	1	22.63	22.63	7.00	22.50
10	*526700F	1	27.75	27.75	7.75	28.50
12	*526701F	1	30.00	30.00	8.50	30.31

### Combination Wye and 1/8 Bend – Reducing (S x S x S)

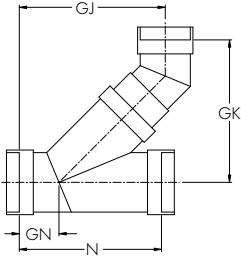

Inch Size	Part Number	Std. Pack	GJ	GK	GN	N
8x8x3	*526709F	1	21.13	15.94	7.00	22.50
8x8x4	*526717F	1	21.00	16.38	7.00	22.50
8x8x6	*526715F	1	22.44	18.88	7.00	22.50
10x10x3	*526707F	1	25.38	19.38	7.75	28.50
10x10x4	*526721F	1	25.38	19.88	7.75	28.50
10x10x6	*526711F	1	26.56	22.19	7.75	28.50
10x10x8	*526712F	1	28.50	27.63	7.75	28.50
12x12x4	*526720F	1	27.00	20.63	8.50	30.31
12x12x6	*526718F	1	28.38	23.25	8.50	30.31
12x12x8	*526719F	1	30.06	28.31	8.50	30.31
12x12x10	*526710F	1	31.50	30.50	8.50	30.31

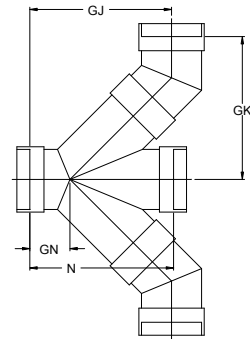

### Combo Wye and 1/8 Bend – Double (S x S x S x S)

Inch Size	Part Number	Std. Pack	GJ	GK	GN	N
8	*526816F	1	22.63	22.63	7.00	22.50
10	*526800F	1	27.75	27.75	7.75	28.50
12	*526801F	1	30.00	30.00	8.50	30.31

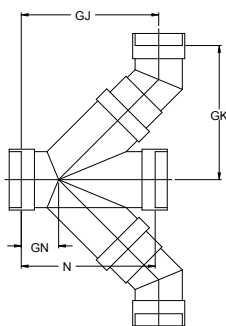

### Combo Wye and 1/8 Bend – Double Reducing (S x S x S x S)

Inch Size	Part Number	Std. Pack	GJ	GK	GN	N
8x8x3x3	*526809F	1	21.13	15.88	7.00	22.50
8x8x4x4	*526817F	1	21.00	16.38	7.00	22.50
8x8x6x6	*526815F	1	22.44	18.88	7.00	22.50
10x10x3x3	*526807F	1	25.38	19.38	7.75	28.50
10x10x4x4	*526821F	1	25.38	19.88	7.75	28.50
10x10x6x6	*526811F	1	26.56	22.19	7.75	28.50
10x10x8x8	*526812F	1	28.50	27.63	7.75	28.50
12x12x4x4	*526820F	1	27.00	20.63	8.50	30.31
12x12x6x6	*526818F	1	28.38	23.25	8.50	30.31
12x12x8x8	*526819F	1	30.06	28.31	8.50	30.31
12x12x10x10	*526810F	1	31.50	30.50	8.50	30.31

^ = 40% Restock Charge

\* = Non-Cancelable / Non-Returnable

Dimensions are subject to change. Please see online "Price Lists" at <http://www.gfpiping.com> for up-to-date information.

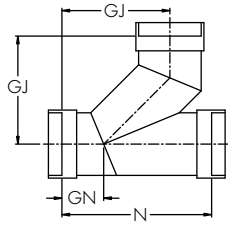

### Sanitary Tee (S x S x S)

Inch Size	Part Number	Std. Pack	GJ	GN	N
8	*526158F	1	15.56	7.00	22.50
10	*526155F	1	20.75	7.75	28.50
12	*526157F	1	22.00	8.50	30.31

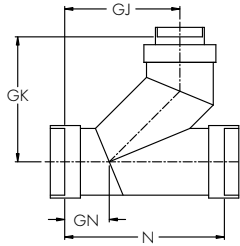

### Sanitary Tee - Reducing (S x S x S)

Inch Size	Part Number	Std. Pack	GJ	GK	GN	N
8x8x3	*526142F	1	15.56	16.35	7.00	22.50
8x8x4	*526140F	1	15.56	16.35	7.00	22.50
8x8x6	*526141F	1	15.56	17.00	7.00	22.50
10x10x3	*526120F	1	20.75	21.50	7.75	28.50
10x10x4	*526121F	1	20.75	21.75	7.75	28.50
10x10x6	*526122F	1	20.75	22.00	7.75	28.50
10x10x8	*526123F	1	20.75	22.63	7.75	28.50
12x12x4	*526132F	1	22.00	22.75	8.50	30.31
12x12x6	*526133F	1	22.00	23.31	8.50	30.31
12x12x8	*526135F	1	22.00	23.75	8.50	30.31
12x12x10	*526125F	1	22.00	24.75	8.50	30.31

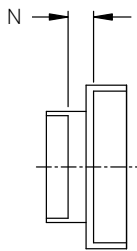

### Pipe Increaser (S x S)

Inch Size	Part Number	Std. Pack	N
8x3	*527035F	1	1.50
8x4	*527034F	1	1.94
8x6	*527033F	1	1.63
10x3	*527040F	1	1.00
10x4	*527030F	1	1.18
10x6	*527031F	1	1.50
10x8	*527032F	1	2.12
12x4	*527036F	1	1.00
12x6	*527037F	1	1.50
12x8	*527038F	1	2.00
12x10	*527039F	1	3.00

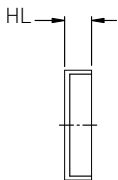

### Cap (S)

Inch Size	Part Number	Std. Pack	HL
8	*527088	1	1.81
10	*527090F	1	3.38
12	*527092F	1	3.38

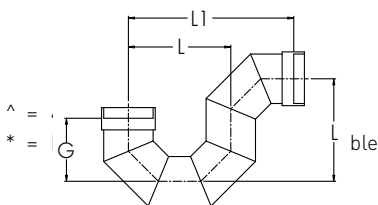

### P-Trap (S x S)

Inch Size	Part Number	Std. Pack	G	L	L1
8	*527208F	1	12.25	18.25	30.50
10	*527210F	1	14.25	22.25	36.50
12	*527212F	1	16.25	26.50	42.75



# Large Diameter Fusion Fittings — PPNFR

P/L 21 Fabricated (part number ends with "F")

Material: Non-Flame Retardant Polypropylene;

8" through 12" fittings require the use of a metal band clamp; metal band clamps must be ordered separately

**Note:** Custom fittings available on request

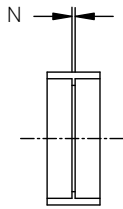

## Coupling (S x S)

Inch Size	Part Number	Std. Pack	N
8	*7008	5	0.25
10	*7010	1	0.25
12	*7020	3	0.25

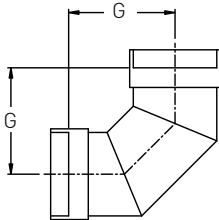

## 1/4 Bend – 3 Segment (S x S)

Inch Size	Part Number	Std. Pack	G
8	*6258F	1	12.25
10	*6255F	1	14.25
12	*6257F	1	16.25

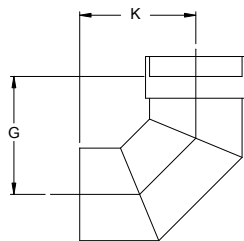

## 1/4 Bend – Street (Spg x S)

Inch Size	Part Number	Std. Pack	G	K
8	*6458F	1	12.25	12.00
10	*6455F	1	14.25	14.00
12	*6457F	1	16.25	16.00

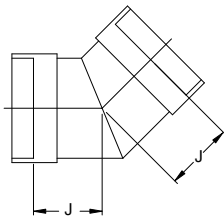

## 1/8 Bend (S x S)

Inch Size	Part Number	Std. Pack	J
8	*6508F	1	6.94
10	*6505F	1	7.75
12	*6507F	1	8.50

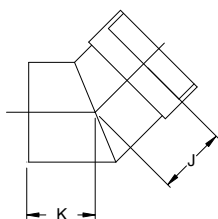

## 1/8 Bend – Street (Spg x S)

Inch Size	Part Number	Std. Pack	J	K
8	*6408F	1	6.94	6.69
10	*6405F	1	7.75	7.25
12	*6407F	1	8.50	8.25

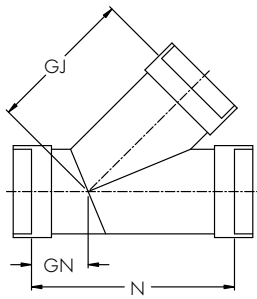

### 45° Wye (S x S x S)

Inch Size	Part Number	Std. Pack	GJ	GN	N
8	*6308F	1	15.50	7.00	22.50
10	*6305F	1	20.75	7.75	28.50
12	*6300F	1	22.00	8.50	30.31

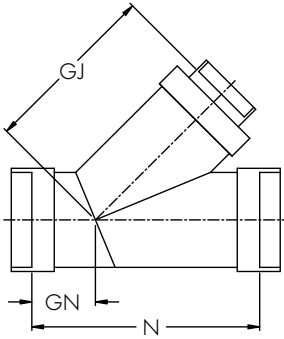

### 45° Wye – Reducing (S x S x S)

Inch Size	Part Number	Std. Pack	GJ	GN	N
8x8x3	*6347F	1	16.82	7.00	22.50
8x8x4	*6346F	1	17.31	7.00	22.50
8x8x6	*6345F	1	17.00	7.00	22.50
10x10x3	*6321F	1	21.69	7.75	28.50
10x10x4	*6322F	1	20.75	7.75	28.50
10x10x6	*6323F	1	22.00	7.75	28.50
10x10x8	*6324F	1	22.63	7.75	28.50
12x12x4	*6332F	1	22.06	8.50	30.31
12x12x6	*6333F	1	23.31	8.50	30.31
12x12x8	*6334F	1	23.75	8.50	30.31
12x12x10	*6335F	1	24.75	8.50	30.31

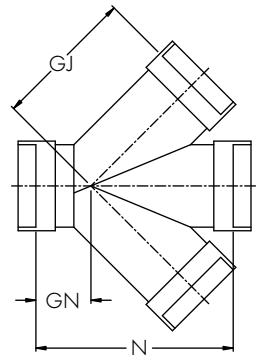

### 45° Wye – Double (S x S x S x S)

Inch Size	Part Number	Std. Pack	GJ	GN	N
8	*6352F	1	15.59	7.00	22.50
10	*6355F	1	20.75	7.75	28.50
12	*6350F	1	22.00	8.50	30.31

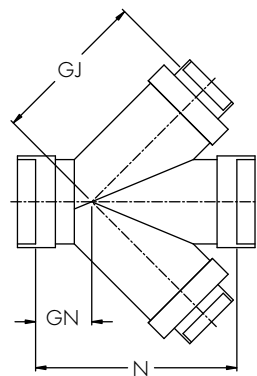

### 45° Wye – Double Reducing (S x S x S x S)

Inch Size	Part Number	Std. Pack	GJ	GN	N
8x8x3x3	*6389F	1	16.82	7.00	22.50
8x8x4x4	*6388F	1	17.31	7.00	22.50
8x8x6x6	*6386F	1	17.00	7.00	22.50
10x10x3x3	*6370F	1	21.75	7.75	28.50
10x10x4x4	*6371F	1	20.75	7.75	28.50
10x10x6x6	*6372F	1	22.25	7.75	28.50
10x10x8x8	*6373F	1	22.75	7.75	28.50
12x12x4x4	*6382F	1	22.06	8.50	30.31
12x12x6x6	*6383F	1	23.50	8.50	30.31
12x12x8x8	*6384F	1	24.00	8.50	30.31
12x12x10x10	*6385F	1	25.00	8.50	30.31

^ = 40% Restock Charge

\* = Non-Cancelable / Non-Returnable

Dimensions are subject to change. Please see online "Price Lists" at <http://www.gfpiping.com> for up-to-date information.

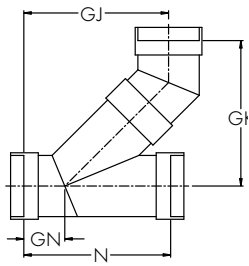

### Combination Wye and 1/8 Bend (S x S x S)

Inch Size	Part Number	Std. Pack	GJ	GK	GN	N
8	*6716F	1	22.63	22.63	7.00	22.50
10	*6700F	1	27.75	27.75	7.75	28.50
12	*6701F	1	30.00	30.00	8.50	30.31

### Combination Wye and 1/8 Bend – Reducing (S x S x S)

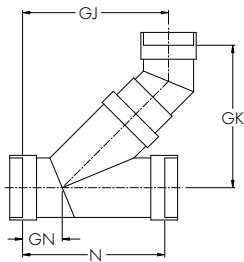

Inch Size	Part Number	Std. Pack	GJ	GK	GN	N
8x8x3	*6709F	1	21.13	15.94	7.00	22.50
8x8x4	*6717F	1	21.00	16.38	7.00	22.50
8x8x6	*6715F	1	22.44	18.88	7.00	22.50
10x10x3	*6707F	1	25.38	19.38	7.75	28.50
10x10x4	*6721F	1	25.38	19.88	7.75	28.50
10x10x6	*6711F	1	26.56	22.19	7.75	28.50
10x10x8	*6712F	1	28.50	27.63	7.75	28.50
12x12x4	*6720F	1	27.00	20.63	8.50	30.31
12x12x6	*6718F	1	28.38	23.25	8.50	30.31
12x12x8	*6719F	1	30.06	28.31	8.50	30.31
12x12x10	*6710F	1	31.50	30.50	8.50	30.31

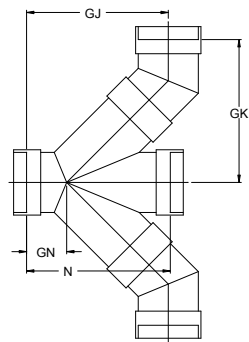

### Combo Wye and 1/8 Bend – Double (S x S x S x S)

Inch Size	Part Number	Std. Pack	GJ	GK	GN	N
8	*6816F	1	22.63	22.63	7.00	22.50
10	*6800F	1	27.75	27.75	7.75	28.50
12	*6801F	1	30.00	30.00	8.50	30.31

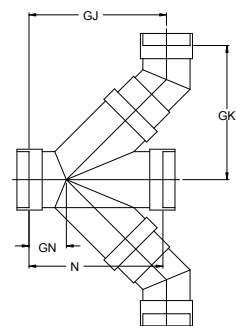

### Combo Wye and 1/8 Bend – Double Reducing (S x S x S x S)

Inch Size	Part Number	Std. Pack	GJ	GK	GN	N
8x8x3x3	*6809F	1	21.13	15.88	7.00	22.50
8x8x4x4	*6817F	1	21.00	16.38	7.00	22.50
8x8x6x6	*6815F	1	22.44	18.88	7.00	22.50
10x10x3x3	*6807F	1	25.38	19.38	7.75	28.50
10x10x4x4	*6821F	1	25.38	19.88	7.75	28.50
10x10x6x6	*6811F	1	26.56	22.19	7.75	28.50
10x10x8x8	*6812F	1	28.50	27.63	7.75	28.50
12x12x4x4	*6820F	1	27.00	20.63	8.50	30.31
12x12x6x6	*6818F	1	28.38	23.25	8.50	30.31
12x12x8x8	*6819F	1	30.06	28.31	8.50	30.31
12x12x10x10	*6810F	1	31.50	30.50	8.50	30.31

^ = 40% Restock Charge

\* = Non-Cancelable / Non-Returnable

Dimensions are subject to change. Please see online "Price Lists" at <http://www.gfpiping.com> for up-to-date information.

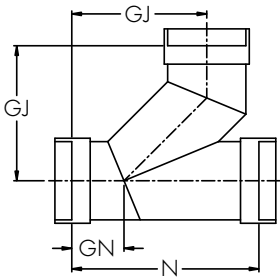

### Sanitary Tee (S x S x S)

Inch Size	Part Number	Std. Pack	GJ	GN	N
8	*6158F	1	15.50	7.00	22.50
10	*6155F	1	20.75	7.75	28.50
12	*6157F	1	22.00	8.50	30.31

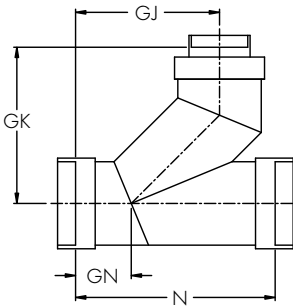

### Sanitary Tee - Reducing (S x S x S)

Inch Size	Part Number	Std. Pack	GJ	GK	GN	N
8 x 8 x 3	*6142F	1	15.50	16.35	7.00	22.50
8 x 8 x 4	*6140F	1	15.50	16.35	7.00	22.50
8 x 8 x 6	*6138F	1	15.50	17.00	7.00	22.50
10 x 10 x 3	*6120F	1	20.75	21.50	7.75	28.50
10 x 10 x 4	*6121F	1	20.75	21.75	7.75	28.50
10 x 10 x 6	*6122F	1	20.75	22.00	7.75	28.50
10 x 10 x 8	*6123F	1	20.75	22.63	7.75	28.50
12 x 12 x 4	*6132F	1	22.00	22.75	8.50	30.31
12 x 12 x 6	*6133F	1	22.00	23.31	8.50	30.31
12 x 12 x 8	*6135F	1	22.00	23.75	8.50	30.31
12 x 12 x 10	*6137F	1	22.00	24.75	8.50	30.31

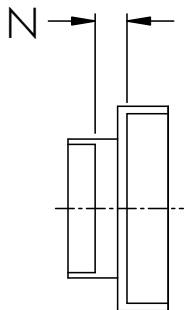

### Pipe Increaser (S x S)

Inch Size	Part Number	Std. Pack	N
8 x 3	*7035F	1	1.25
8 x 4	*7034F	1	1.18
8 x 6	*7033F	1	1.63
10 x 3	*7040F	1	1.00
10 x 4	*7030F	1	1.18
10 x 6	*7031F	1	1.50
10 x 8	*7032F	1	2.12
12 x 4	*7036F	1	1.00
12 x 6	*7037F	1	1.50
12 x 8	*7038F	1	2.00
12 x 10	*7039F	1	3.00

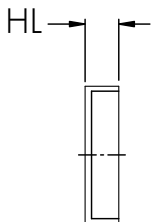

### Cap (S)

Inch Size	Part Number	Std. Pack	HL
8	*7088	1	1.81
10	*7090F	1	3.38
12	*7092F	1	3.38

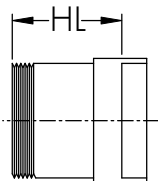

### Male Adapter (S x MPT)

Inch Size	Part Number	Std. Pack	HL
8	*6878F	1	4.38

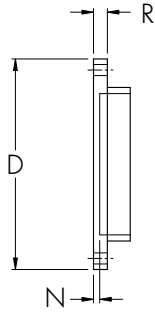

### Flange – Van Stone 150 lb. Pattern (S)

Flange ring material: PVC

Inch Size	Part Number	Std. Pack	# holes	Bolt Hole Dia.	Bolt Cir. Dia.	D	N	R	Bolt Length
8	*6928	1	8	0.88	11.75	13.50	0.44	1.71	3.50
10	*6930	1	12	1.00	14.25	16.00	0.50	1.73	3.75
12	*6932	1	12	1.00	17.00	19.00	0.50	1.71	4.00

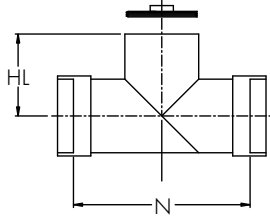

### Cleanout Tee with Plug (S x S x FT)

Inch Size	Part Number	Std. Pack	HL	N
8	*6119AF	1	8.00	22.50
10	*6120AF	1	10.00	28.50
12	*6121AF	1	12.00	30.50

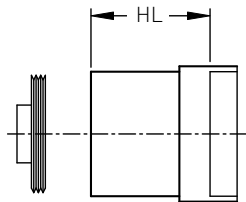

### Cleanout Adapter with Plug (S x FT)

Inch Size	Part Number	Std. Pack	HL
8	*7708AF	1	10.25
10	*7710AF	1	12.25
12	*7712AF	1	14.25

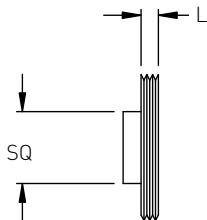

### Plug (MT)

Inch Size	Part Number	Std. Pack	L	SQ
8	*7058F	1	0.75	4.00
10	*7059F	1	1.00	4.00
12	*7060F	1	1.00	4.00

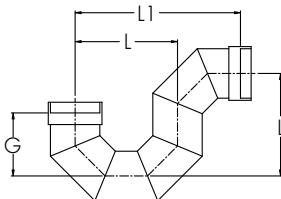

### P-Trap (S x S)

Inch Size	Part Number	Std. Pack	G	L	L1
8	*7208F	1	12.25	18.25	30.50
10	*7210F	1	14.25	22.25	36.50
12	*7212F	1	16.25	26.50	42.75

^ = 40% Restock Charge

\* = Non-Cancelable / Non-Returnable

Dimensions are subject to change. Please see online "Price Lists" at <http://www.gfpiping.com> for up-to-date information.

# Fuseal Fusion Accessories

P/L 07 Fusion Accessories

Standard Pack Quantities; No broken Packs

## Fusion Collar with Plastic Clamp

6" fusion collars without plastic clamp



Inch Size	Part Number	Std. Pack
1½	*6282	10
2	*6283	10
3	*6284	10
4	*6285	10
6	*6287	10

## Loose Coil



Inch Size	Part Number	Std. Pack
8	*6088	10
10	*6090	10
12	*6092	10

## Plastic Clamp



Inch Size	Part Number	Std. Pack
1½	*FU1282	10
2	*FU1283	10
3	*FU1284	10
4	*FU1285	10

## Metal Clamp

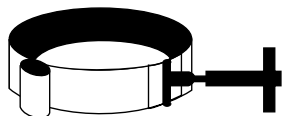

Inch Size	Part Number	Std. Pack
4	*FU110	1
6	*FU112	1
8	*FU118	4
10	*FU119	4
12	*FU120	4

^ = 40% Restock Charge

\* = Non-Cancelable / Non-Returnable

Dimensions are subject to change. Please see online "Price Lists" at <http://www.gfpiping.com> for up-to-date information.

# PPFR Mechanical Joint Fittings – PPFR

P/L 53: Mechanical Joint

Material: Flame-Retardant Polypropylene

Standard pack quantities only; no broken packs

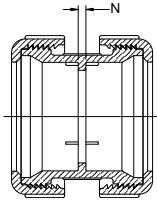

## Coupling (MJ x MJ)

Inch Size	Part Number	Std. Pack	N
1½	9001	4	0.13
2	9002	2	0.13
3	9003	1	0.25
4	9004	1	0.25

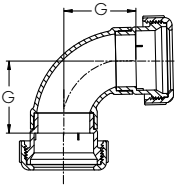

## 1/4 Bend – Short Sweep (MJ x MJ)

Inch Size	Part Number	Std. Pack	G
1½	8251	4	1.75
2	8252	2	2.31
3	8253	1	3.07
4	8254	1	3.88

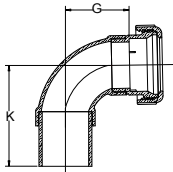

## 1/4 Bend – Street (Spg x MJ)

Inch Size	Part Number	Std. Pack	G	K
1½	8451	4	1.75	3.10
2	8452	2	2.31	3.75
3	8453	1	4.25	6.69
4	8454	1	5.06	7.89

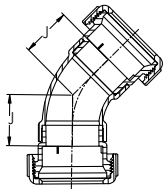

## 1/8 Bend (MJ x MJ)

Inch Size	Part Number	Std. Pack	J
1½	8501	4	1.09
2	8502	2	1.41
3	8503	1	3.06
4	8504	1	3.50

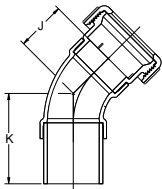

## 1/8 Bend – Street (Spg x MJ)

Inch Size	Part Number	Std. Pack	J	K
1½	8401	4	1.13	2.45
2	8402	2	1.41	1.84
3	8403	1	2.94	5.38
4	8404	1	3.38	6.56

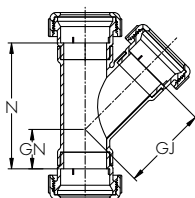

## 45° Wye (MJ x MJ x MJ)

Inch Size	Part Number	Std. Pack	GJ	GN	N
1½	8301	4	3.25	1.13	4.00
2	8302	2	4.13	1.38	5.00
3	8303	1	6.19	2.94	9.01
4	8304	1	7.69	3.19	10.66

### 45° Wye – Reducing (MJ x MJ x MJ)

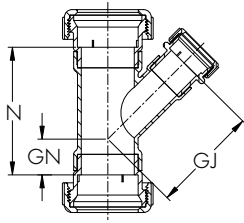

Inch Size	Part Number	Std. Pack	GJ	GN	N
2x2x1½	8325	2	5.75	1.38	5.00
3x3x1½	8324	1	6.25	2.06	7.38
3x3x2	8326	1	6.24	2.06	7.38
4x4x2	8328	1	7.17	1.56	7.46
4x4x3	8327	1	7.19	2.25	9.19

### 45° Wye – Double (MJ x MJ x MJ x MJ)

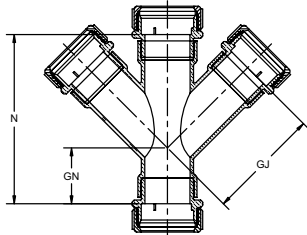

Inch Size	Part Number	Std. Pack	GJ	GN	N
1½	*6380	1	4.97	2.60	7.58
2	*6381	1	5.18	2.55	7.72
3	*6382	1	6.19	2.82	10.01
4	*6383	1	7.58	3.07	11.66

### 45° Wye – Double Reducing (MJ x MJ x MJ x MJ)

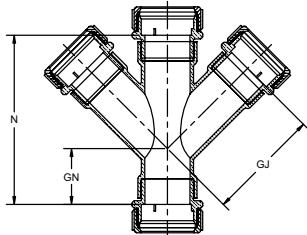

Inch Size	Part Number	Std. Pack	GJ	GN	N
2x2x1½	*6384	1	5.62	2.55	7.72
3x3x1½	*6389	1	6.24	2.07	8.38
3x3x2	*6385	1	5.79	2.07	8.38
4x4x2	*6386	1	6.73	1.58	8.42
4x4x3	*6387	1	7.19	2.26	10.03

### Combination Wye and 1/8 Bend (MJ x MJ x MJ)

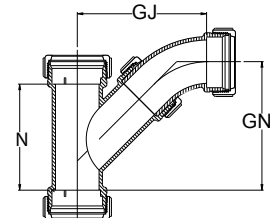

Inch Size	Part Number	Std. Pack	GJ	GN	N
1½	9301	4	5.13	5.13	4.00
2	9302	2	6.31	6.25	5.00

### Long Turn Tee Wye (MJ x MJ x MJ)

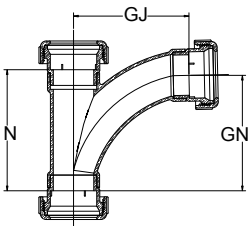

Inch Size	Part Number	Std. Pack	GJ	GN	N
3	9303	1	8.75	8.88	9.06
4	9304	1	11.31	11.31	11.06

### Combination Wye and 1/8 Bend – Reducing (MJ x MJ x MJ)

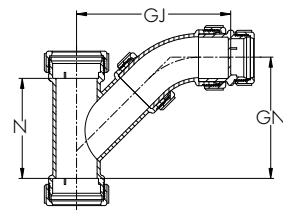

Inch Size	Part Number	Std. Pack	GJ	GN	N
2x2x1½	9320	2	7.94	6.31	5

### Long Turn Tee Wye – Reducing (S x S x S)

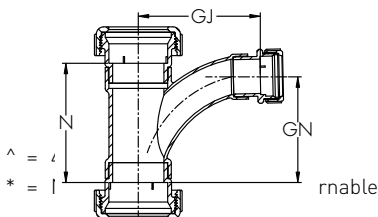

Inch Size	Part Number	Std. Pack	GJ	GN	N
3x3x1½	9326	1	7.25	6.31	7.13
3x3x2	9327	1	7.31	6.31	7.13
4x4x2	9337	1	7.75	6.31	7.25
4x4x3	9338	1	9.25	8.75	9.25



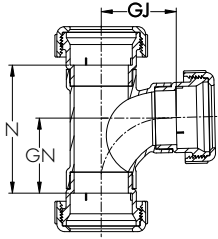

### Sanitary Tee (MJ x MJ x MJ)

Inch Size	Part Number	Std. Pack	GJ	GN	N
1½	8151	4	1.75	1.75	3.00
2	8152	2	2.31	2.31	3.69
3	8153	1	4.25	4.25	7.25
4	8154	1	5.06	5.06	8.50

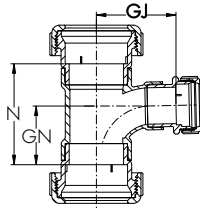

### Sanitary Tee - Reducing (MJ x MJ x MJ)

Inch Size	Part Number	Std. Pack	GJ	GN	N
2x2x1½	8126	2	3.94	2.31	3.69
3x3x1½	8131	1	4.50	3.31	5.69
3x3x2	8130	1	4.50	3.31	5.69
4x4x2	8134	1	4.94	3.25	5.56
4x4x3	8136	1	4.75	4.19	7.13

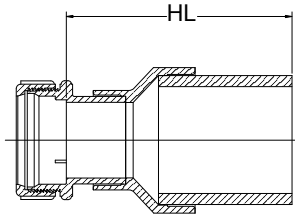

### Reducer Bushing (Spg x S)

Inch Size	Part Number	Std. Pack	HL
2x1½	8752	2	1.63
3x1½	8762	1	6.12
3x2	8754	1	6.18
4x2	8758	1	7.00
4x3	8756	1	6.12

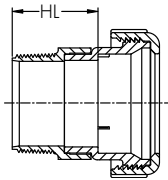

### Male Adapter (MJ x MPT)

Inch Size	Part Number	Std. Pack	HL
1½	8871	4	1.19
2	8872	2	1.22
3	8873	1	2.13
4	8874	1	2.25

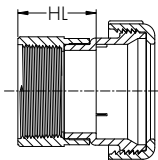

### Female Adapter (MJ x FPT)

Inch Size	Part Number	Std. Pack	HL
1½	8891	4	1.19
2	8892	2	1.22
3	8893	1	2.93
4	8894	1	3.00

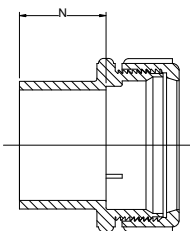

### Fuseal Adapter (MJ x Spg)

Inch Size	Part Number	Std. Pack	N
1½	9651	4	1.49
2	9652	2	1.17
3	9653	1	1.19
4	9654	1	1.20

Dimensions are subject to change. Please see online "Price Lists" at <http://www.gfpiping.com> for up-to-date information.

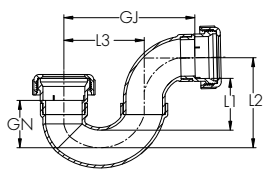

### P Trap (MJ x MJ)

Inch Size	Part Number	Std. Pack	GJ	GN	L1	L2	L3
1½	9211E	4	5.25	1.31	2.69	4.25	3.50
2	9212E	2	6.44	2.25	2.53	4.44	5.00
3	9213E	1	9.88	3.63	4.56	8.19	6.75
4	9214E	1	12.06	5.06	5.19	9.38	8.50

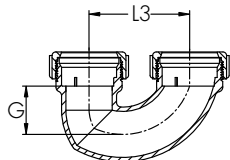

### U Bend (MJ x MJ)

Inch Size	Part Number	Std. Pack	G	L3
1½	9211	2	1.22	3.50

### MJ Kits

(includes Nut, Seal Ring and Grab Ring)

Inch Size	Part Number	Std. Pack
1½	*9001-KIT	10
2	*9002-KIT	10
3	*9003-KIT	10
4	*9004-KIT	10



### Spanner Wrench

Inch Size	Part Number	Std. Pack
1½ - 2	*8100	1
3 - 4	*8101	1

## Neutralization Tanks and Accessories

P/L 30

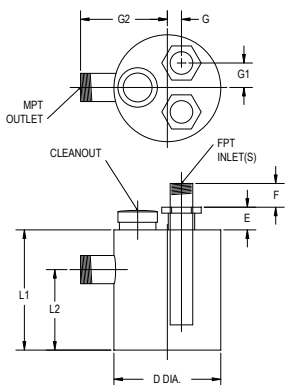

### HDPE Round Dilution Tank with Cleanout – Black (FPT Inlet x MPT Outlet)

Size (gal.)	Part Number	Standard Inlet, inch	Standard Outlet, inch	No. of Inlets	D	E	F	G	G1	G2	L1	L2
1.5	*PETANK-9151B	1½	2	1	9.00	1.94	0 to 10	1.31	2.06	7.31	10.13	6.75
1.5	*PETANK-9152B	1½	2	2	9.00	1.94	0 to 10	1.31	2.06	7.31	10.13	6.75

### HDPE Round Dilution Tank with Cleanout – Translucent (FPT Inlet x MPT Outlet)

Size (gal.)	Part Number	Standard Inlet, inch	Standard Outlet, inch	No. of Inlets	D	E	F	G	G1	G2	L1	L2
1.5	*PETANK-9151T	1½	2	1	9.00	1.94	0 to 10	1.31	2.06	7.31	10.13	6.75
1.5	*PETANK-9152T	1½	2	2	9.00	1.94	0 to 10	1.31	2.06	7.31	10.13	6.75

### HDPE Rectangular Dilution Tank with Cleanout – Black (FPT Inlet x FPT Outlet)

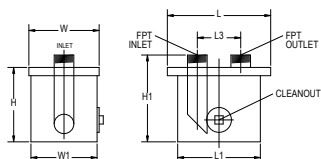

Size (gal.)	Part Number	Standard Inlet/Outlet, inch	H	H1	L	L1	L3	W	W1
1.5	*PETANK-815	1½	9.00	10.50	12.50	10.00	5.25	8.50	8.00
1.5	*PETANK-802	2	9.00	10.50	12.50	10.00	5.25	8.50	8.00

## HDPE Round Neutralization Tank, Bolted Top (FPT Inlet x FPT Outlet x FPT Vent)

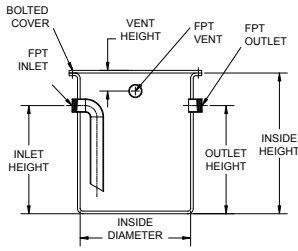

Size (gal.)	Part Number	Inside Dimensions Dia. x Ht., inch	Standard Inlet/Outlet (FPT)	Standard Vent (FPT)	Standard Inlet/Outlet Height (from bottom)	Standard Vent Height (from top)
5	*PETANK-005	11 x 14	2	2	11	2
15	*PETANK-015	18 x 15	3	2	11	2
30	*PETANK-030	18 x 29	3	2	22	3
55	*PETANK-055	22 x 36	3	2	27	3
100	*PETANK-100	28 x 42	4	3	36	3
150	*PETANK-150	31 x 48	4	3	38	3
200	*PETANK-200	36 x 48	4	3	38	3
275	*PETANK-275	42 x 48	4	3	38	3
300	*PETANK-300	36 x 73	4	3	38	3
350	*PETANK-350	48 x 48	4	3	38	3
500	*PETANK-500	52 x 60	6	3	52	3

Welded cover and fiberglass reinforced tanks are available; contact factory for pricing.

### Adder for larger than standard HDPE fitting sizes

	Inlet	Outlet	Vent
	Part No.	Part No.	Part No.
2" → 3"	*PEI2-3	*PEO2-3	*PEV2-3
3" → 4"	*PEI3-4	*PEO3-4	*PEV3-4
4" → 6"	*PEI4-6	*PEO4-6	*PEV4-6

## PP Round Neutralization Tank, Bolted Top (FPT Inlet x FPT Outlet x FPT Vent)

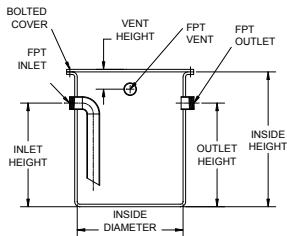

Size (gal.)	Part Number	Inside Dimensions Dia. x Ht., Inch	Standard Inlet/Outlet (FPT)	Standard Vent (FPT)	Standard Inlet/Outlet Height (from bottom)	Standard Vent Height (from top)
5	*PPTANK-005	11 x 14	2	2	11	2
15	*PPTANK-015	18 x 15	3	2	11	2
30	*PPTANK-030	18 x 29	3	2	22	3
55	*PPTANK-055	22 x 36	3	2	27	3
100	*PPTANK-100	28 x 42	4	3	36	3
150	*PPTANK-150	31 x 48	4	3	38	3
200	*PPTANK-200	36 x 48	4	3	38	3
275	*PPTANK-275	42 x 48	4	3	38	3
350	*PPTANK-350	48 x 48	4	3	38	3
500	*PPTANK-500	52 x 60	6	3	52	3

Welded cover and fiberglass reinforced tanks are available; contact factory for pricing.

### Adder for larger than standard PP fitting sizes

	Inlet	Outlet	Vent
	Part Number	Part Number	Part Number
2" → 3"	*PPI2-3	*PPO2-3	*PPV2-3
3" → 4"	*PPI3-4	*PPO3-4	*PPV3-4
4" → 6"	*PPI4-6	*PPO4-6	*PPV4-6

### Manway Access

Size	Part Number
15"	*MWY-15

### Limestone Chips (50 lb bag)

Size	Part Number
1" - 3"	*LSCHIPS

# GF Piping Systems

## Round Neutralization Tank Order Sheet

Mark desired location of tank's connections by inserting I (inlet), O (outlet), and V (vent) in the diagram below.

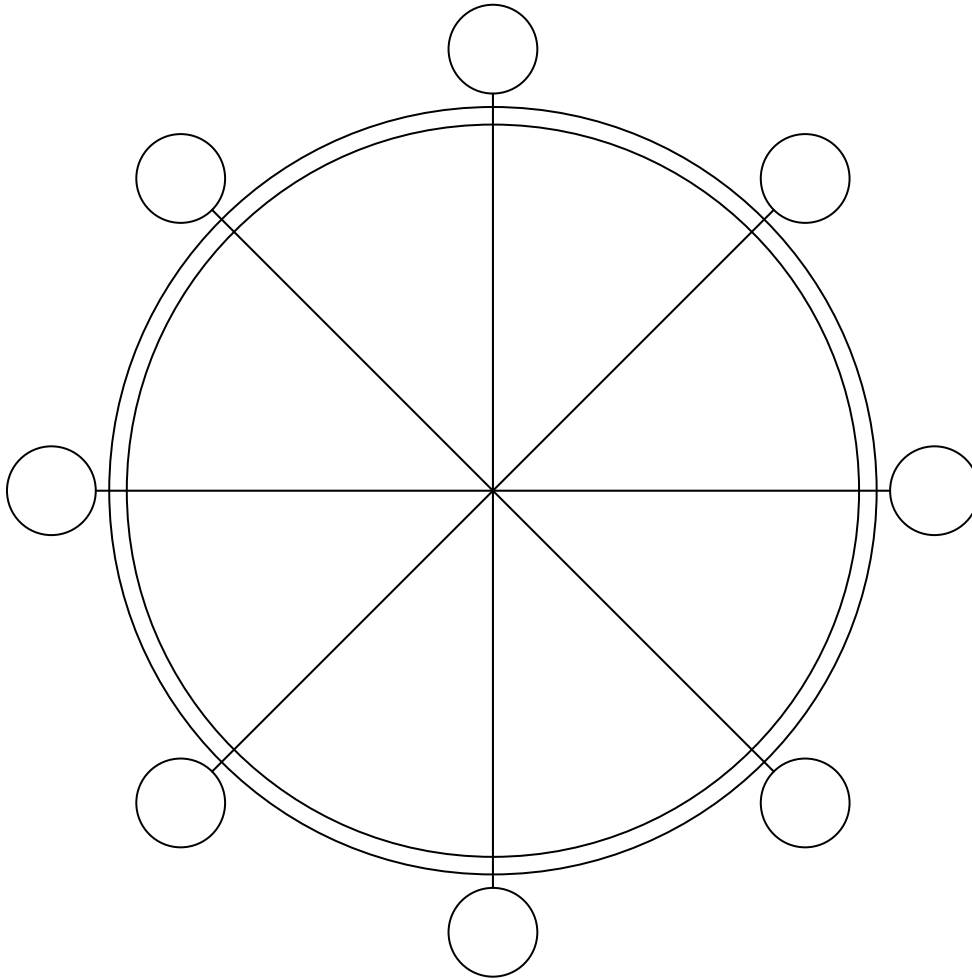

Part Number: \_\_\_\_\_

Size: \_\_\_\_\_

Material: \_\_\_\_\_

Inlet Size: \_\_\_\_\_

Outlet Size: \_\_\_\_\_

Vent Size: \_\_\_\_\_

Tank Diameter: \_\_\_\_\_

Tank Height: \_\_\_\_\_

Inlet Height (from bottom): \_\_\_\_\_

Outlet Height (from bottom): \_\_\_\_\_

Vent Depth (from top): \_\_\_\_\_

All tanks are custom-made to the supplied specifications and are not returnable.  
An authorized drawing is to be furnished for proper dimensions and locations of connections.  
No order will be accepted without order sheet.  
Once the order is accepted, the tank is non-cancelable.

# GF Piping Systems

Corrosive Waste Piping System  
Specification Submittal Data Sheet  
Fuseal Polypropylene Pipe and Fittings

## Pipe

Pipe will be manufactured to the dimensions and tolerances of ASTM F1412. The polypropylene material will be either flame retardant (FR) or non flame retardant (NFR) and will conform to ASTM D4101. The pipe will conform to NSF-cw, CSA, UPC®, The City of Los Angeles and the Commonwealth of Massachusetts standards.

- PPFR Sch.40 Group I Pipe - 10 ft. Lengths
- PPFR Sch.80 Group I Pipe - 10 ft. Lengths
- PPNFR Sch.40 Group I Pipe - 20 ft. Lengths
- PPNFR Sch.80 Group II Pipe - 20 ft. Lengths

## Fittings

Molded and fabricated fittings will be manufactured to the dimensions and tolerances of ASTM F1412. Molded fitting patterns will conform to ASTM D3311. The polypropylene material will conform to ASTM D4101. The pipe will conform to NSF-cw, CSA, UPC®, The City of Los Angeles and the Commonwealth of Massachusetts standards.

- PPFR Sch.40 Molded
- PPFR Sch.40 Fabricated
- PPNFR Sch.40 Fabricated

## Joining

Pipe and fittings are joined by either electrofusion or by mechanical joint. Electrofusion joints will conform to ASTM F1290 and consist of a polypropylene jacketed wire. Mechanical joints shall consist of a seal and grab ring with chemical resistance equal to the pipe and fittings.

- Electrofusion
- Mechanical Joint

**Job Name:** \_\_\_\_\_

**Job Location:** \_\_\_\_\_

**Engineer:** \_\_\_\_\_

**Contractor:** \_\_\_\_\_

**Representative:** \_\_\_\_\_

UPC is a registered trademark of IAPMO

^ = 40% Restock Charge

\* = Non-Cancelable / Non-Returnable

# GF Piping Systems

Corrosive Waste Piping System

Specification Submittal Data Sheet

Fuseal Nickel Bronze Floor Cleanout

## Floor Cleanout

Corrosion-resistant finished floor cleanout is manufactured from flame retardant (FR) polypropylene material conforming to ASTM D4101. The assembly includes a molded cleanout, countersunk plug, an adjustable access housing and removable cover. The housing has approximately 2" of adjustment. The access housing and cover are cast from 12% nickel bronze. AWCO (Acid Waste Cleanout) and USA are cast on the top cover.

- Nickel Bronze Housing and Cover
- 3" PPFR Sch.40 Molded with Nickel Bronze Housing and Cover
- 4" PPFR Sch.40 Molded with Nickel Bronze Housing and Cover

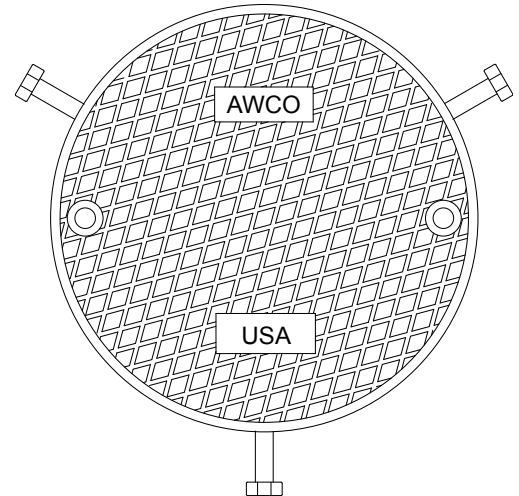
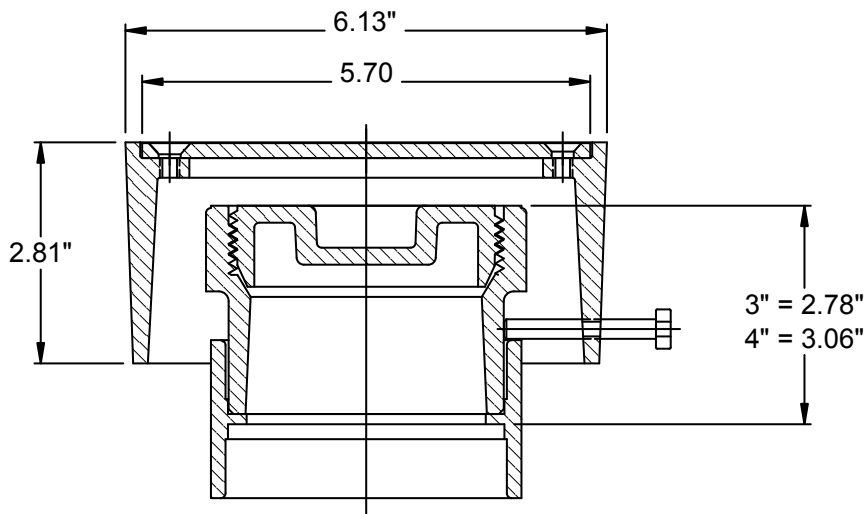

Job Name: \_\_\_\_\_

Job Location: \_\_\_\_\_

Engineer: \_\_\_\_\_

Contractor: \_\_\_\_\_

Representative: \_\_\_\_\_

# GF Piping Systems

Corrosive Waste Piping System  
 Specification Submittal Data Sheet  
 Fuseal Floor Drain

## Floor Drain

Fixed height, moderate traffic floor drain with 8" diameter grate, sediment strainer with removable flashing collar that is manufactured from flame retardant (FR) polypropylene material conforming to ASTM D4101. The maximum flow rate is 44 GPM at 2" water level. The average failure load for the grate is 3,300 pounds with a maximum live load of 825 pounds. A boss is provided on the body of the drain which can be drilled and tapped to accept a primer line up to 1/2" NPT.

- 2" PPFR Sch.40 Molded Floor Drain
- 3" PPFR Sch.40 Molded Floor Drain
- 4" PPFR Sch.40 Molded Floor Drain
- 6" PPFR Sch.40 Molded Floor Drain
- Anti-Splash Funnel

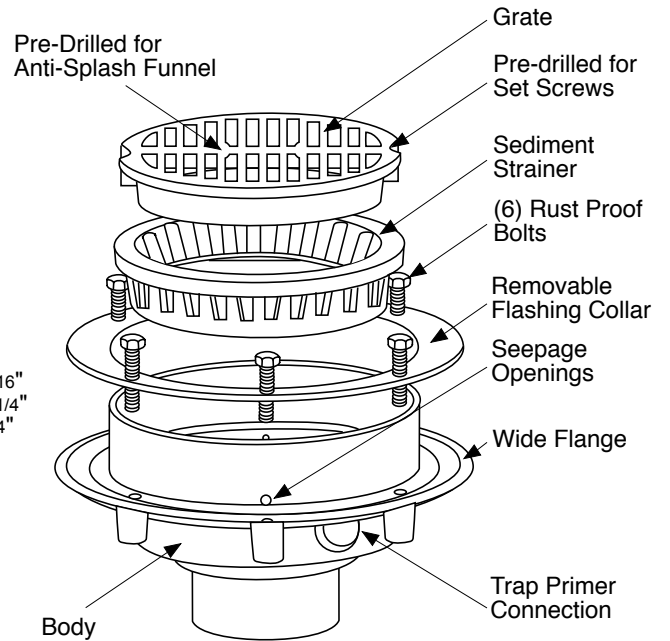
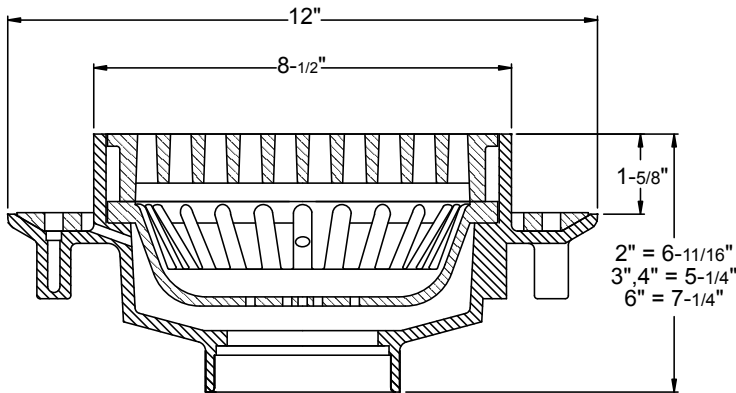

Fuseal PP

Job Name: \_\_\_\_\_

Job Location: \_\_\_\_\_

Engineer: \_\_\_\_\_

Contractor: \_\_\_\_\_

Representative: \_\_\_\_\_

# GF Piping Systems

Corrosive Waste Piping System  
Specification Submittal Data Sheet  
Acid Neutralization Tank

## Tanks

Tanks shall be seamless construction with uniform wall thickness. The inlet, outlet and vent connections are welded into the tank wall at specified locations. Tanks are complete with a bolt-down cover, gasketing and the necessary bolts, nuts and washers or in welded cover styles with a manhole. Tanks may also be fiberglass reinforced. Tanks shall be tested by filling with water prior to use and inspect for any leaks.

Polyethylene tanks are rotationally molded from virgin High-Density Polyethylene resins conforming to ASTM D1248 for Polyolefin materials and suitable for continuous duty to 180°F, intermittent duty to 212°F. All fittings are molded polyethylene.

Polypropylene tanks are rotationally molded from natural (white) virgin Polypropylene resins conforming to ASTM D1248 for Polyolefin materials and suitable for continuous duty to 200°F, intermittent duty to 220°F. All fittings are molded flame retardant polypropylene.

- HDPE Tank
- PP Tank
- Fiberglass Reinforced
- Bolted Cover
- Welded Cover
- Standard Inlet, Outlet and Vent Connections
- State of Ohio Code Inlet and Outlet Connections

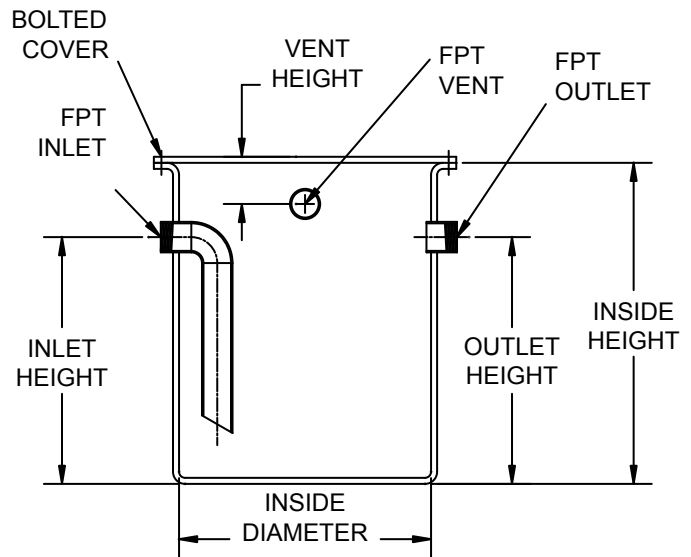

Job Name: \_\_\_\_\_

Job Location: \_\_\_\_\_

Engineer: \_\_\_\_\_

Contractor: \_\_\_\_\_

Representative: \_\_\_\_\_